

Multi-Use Games Area

Our Multi-Use Games Area (MUGA) was damaged in the storms over the May Bank Holiday. We are looking at options to either repair or replace it. It may also be an opportunity to look at upgrading the games surface.

Quotes have been sought for both repair/refurbishment or replacement with new boundary fencing/boarding. The only quote received so far has been for the clearing of the existing boarding from the site, at a cost of £2100 plus VAT from Eastern Play Services Ltd (attached as Appendix A to this report) who state that the Games Area is not safe in its current state. The most recent report from the play inspector (9th June '21) is summarised below:

10 - Low Risk	
Item:	Site General
Manufacturer:	Owner/Operator
Surface Type:	N/A
Item Quantity:	1
Equipment Compliance:	N/A
Surface Area Compliance:	N/A
Total Findings:	3



Finding 1	Finding 2
There are areas or parts of the timber on the structure that have rotted - Replace all affected timbers	Rot at base of several posts - Consider planning to replace
Finding 3	
Fencing panels disconnected - Remove	

The area is likely to continue to deteriorate, and the boarding cannot be left in situ as this is likely to represent a risk of itself.

At the Community Engagement Day on 3rd July there were a number of requests for smaller football goals with nets, which could be achieved if the seating was taken out and now boundary fencing installed. Other requests included the provision of a 3G Astro turfed area and outdoor table tennis table(s). Outdoor Gym Equipment was also popular as part of further development of the Six Acres and Recreation Ground.

At its July meeting the parish council decided that all the boarding would need to be cleared and any holes arising from post removal made good. The preference was to do this by means of a working party, with the boarding removed off site and stored for possible future recycling.

The clerk was asked to look into quotes and report options to the Estates Committee, for future consultation with the parish as part of preparing a grant funding bid, which could also cover new equipment at the skate park, and the outdoor gym equipment.

Subsequent to the meeting, the site was measured (11m x 13m).

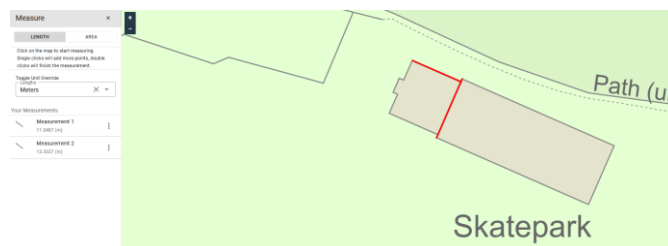

Hilary Workman
Clerk & RFO
July 2021

WPC.EC.21.08.05 – Multi-Use Games Area

The nearest size MUGA identified is 11 x 15m steel, at £14,600 plus 28 hours installation



In view of the limited space available for the installation of a Multi-Use Games Area on that site, it has been suggested that the Estates Committee and Parish Council consider:

- Bounding the site with low level fencing
- Re-purposing the site for outdoor gym equipment, which could:
 - a. Meet an identified demand in the parish supported by evidence from the community engagement day, previous meetings and anecdotal request
 - b. Fit with a demand for and move to more outdoor fitness facilities generated by the recent pandemic,
 - c. Provide an opportunity to link into existing fitness classes based at the Memorial Social centre; and
 - d. Bring the space back into use in the short to medium term, with
- Development of new and larger grant funded MUGA, incorporating 5 aside football, hockey and basketball in a new position near the tennis courts, with possible shared use by the school

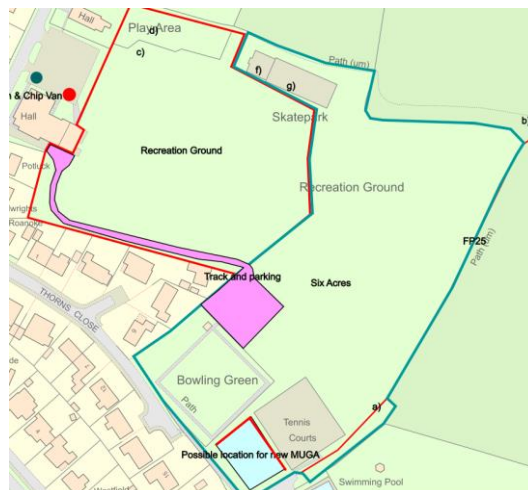

WPC.EC.21.08.05 – Multi-Use Games Area

This would allow for a MUGA up to 20m x 30m

We have created the reference J22212 in our "Sports walls / Ball courts" range. This module is accessible from 6 years.

The size of the module is: 30.20 m wide, 15.20 m. deep, 3.90 m. high.

Specifications

Age range: 6+
Size: 30.20 x 15.20 x 3.90 m

Equipment installation

Number of installers: 3
Installation time: 24:00:00
Concrete volume: 4.20 m³
Total weight: 1588.49 kg
Weight of the heaviest element: 27.36 kg



Photo



Side view

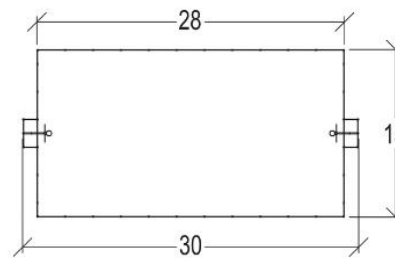

View from above

£22,910 (equipment only)

A range of outdoor fitness equipment to be sited in the existing MUGA space. There are a range of options:

Outdoor fitness stations / Trim trails

Fitness modules and sport trail equipment offer activities to maintain or improve your physical shape.



Vitality areas



Urbanix stations



Metal Trim Trail



Wood trim trails



Street Workout

Dependant on the style of fitness equipment and range, it may be that a re-surfacing of the area be considered (particularly if the range of equipment decided upon includes free-fall opportunities).

Hilary Workman
Clerk & RFO
July 2021

WPC.EC.21.08.05 – Multi-Use Games Area

There is funding for the Teen project replacement in earmarked reserves (£12,500) which could form the basis of seed funding for a larger grant application.

There is an opportunity to apply for funding coming up through West Suffolk's Community Chest (last submission date 29th October 2021), and the clerk is looking for other match funding opportunities.

The summer could be used to consult with residents of the parish about the type of equipment that would be best suited for a re-purposing of the area and development of a new MUGA, building engagement and an understanding of costs.

The September meeting of the parish council could then be used to consider a business case for the proposals and delegate authority to the clerk to apply for grants.

The October meeting of the Estates Committee could then be used to finalise proposals to be included in a grant application, having considered the responses from consultation questions and the engagement day at the skatepark in September.

A grant funding bid would therefore be likely to include:

- Re-purposing the Multi-use games area for outdoor fitness, including:
 - New fitness equipment
 - Re-surfacing if needed
 - Fencing of the area, if not completed in advance
- New equipment to replace grind rails in the skatepark (and consider replacement of half and quarter pipe surfaces based on professional advice)
- Development of a new Multi-Use Games Area, possibly at a site adjacent to the Tennis Courts

And could also include new bow top fencing for both the cemetery road and bury road play areas.

Action:

Councillors discuss and agree on a route forward for development of Outdoor fitness, replacement equipment at the skatepark and new site for MUGA.

Fencing in of the existing MUGA

Three quotes have been requested based on bow top fencing (of a similar style to the skate park), at varying heights of 1m, 1.2m and 2m, including self closing child safe gate for the area, including, where possible, removal of existing boarding and posts, attached as Appendix A to this report.

The parish council has worked with Playforce on two previous projects. Once approved, the work could be delayed until such time as it has been established whether or not a new surface would be required, or a new surface could be inset within the area, with a boundary of wood chippings (for example).

The parish council has power to undertake this work under Public Health Act 1875, s.164. There are earmarked reserves of £12,750, which the parish council could determine to use to fund this work (which could then form part of the parish contribution to the larger

Hilary Workman
Clerk & RFO
July 2021

WPC.EC.21.08.05 – Multi-Use Games Area

project). Transfer of funds from earmarked reserves to the general reserve would then need to be authorised by the parish council at its September meeting.

Recommendation:

Identify the preferred option for replacement bow top fencing, installation, removal of existing boards and posts based on quotes attached as Appendix A for referral to the parish council for costs to be authorised.

QUOTATION

Appendix A

STEELWAY FENSECURE

Steelway Fensecure Ltd

Queensgate Works

Bilston Road

Wolverhampton

West Midlands WV2 2NJ

Tel: 01902 490919

Email: sales@fensecure.co.uk

Website: www.steelway.co.uk

Quoted to:

New Customer

Hilary Workman

Wickhambrook Parish Council

Page : 1 of 2

VAT Reg No. 991247887

QUOTE NO:	QUOTE DATE:	ACCOUNT NO:	CUSTOMER REF:	VAT NO:	CURRENCY
QUO30885	30/07/2021	1F1QUOTE	Play Area	GB 999999999	Sterling

PRODUCT CODE	QUANTITY	DESCRIPTION	UNIT PRICE	LINE VALUE
BTF10027012P - R	48.40	Lin metres of 1.0m high Bowtop Fencing with 12mm infill bars at 101mm centres, 30 x 10 flat top & bottom rails, 50 x 50 SHS Posts, 2.7m standard panel width - To RoSPA guidelines. Galvanized and polyester powder coated	60.11	2909.32
BTP10012P	4	No 1.0m high Corner Posts 50 x 50 SHS, Galvanized and polyester powder coated	31.24	124.96
PSSG120100-P	1	No 1.2m wide x 1.0m high Premier Safe Sprung Self Closing Gate with 12mm infill bars c/w Posts. Right Hand Hung - Open Out From Site unless otherwise requested. Galvanized & Polyester Powder Coated.	474.88	474.88
INSTALLATION	1.00	Sum Installation - budget price Please fill in and return the attached erection checklist. Please be advised that we all have a responsibility under the Health and Safety at Work Act to provide information that will assist in the safe installation of our products.	2187.50	2187.50
SKIP	1	Sum Hire of Skip	310.00	310.00
QUOTE	1.00	All as per our Quotation		
TERMS	1	Terms Nett Monthly Account - Subject to credit clearance. This offer to remain open for acceptance for a period of 14 days from the date of the quotation. Unless otherwise stated where powder coating is specified this is based on our standard range of colours: Green RAL 6005, Yellow RAL 1003, Red RAL 3020, Blue RAL 5010 and Black RAL 9005. Where other colours are required please contact our sales department. Should the Purchaser defer the delivery date after completion of manufacture, we reserve the right to invoice the full value of the goods and charge any storage costs as may be applicable. If storage fees are to be charged we will give fourteen days written notice to enable the Purchaser to make arrangements for collection or delivery. Quotations which include installation are based upon above ground observations, service drawings (if available) and information supplied. If any below ground obstructions or adverse digging conditions are		

QUOTATION

STEELWAY FENSECURE

Steelway Fensecure Ltd

Queensgate Works

Bilston Road

Wolverhampton

West Midlands WV2 2NJ

Tel: 01902 490919

Email: sales@fensecure.co.uk

Website: www.steelway.co.uk

Quoted to:

New Customer

Hilary Workman

Wickhambrook Parish Council

Page : 2 of 2

VAT Reg No. 991247887

QUOTE NO:	QUOTE DATE:	ACCOUNT NO:	CUSTOMER REF:	VAT NO:	CURRENCY
QUO30885	30/07/2021	1F1QUOTE	Play Area	GB 999999999	Sterling

PRODUCT CODE	QUANTITY	DESCRIPTION	UNIT PRICE	LINE VALUE
		<p>encountered which affect the progress of work you will be advised immediately and asked how you wish to proceed.</p> <p>Extra labour will be charged at our standard minimum day rate, based on two men for 10 hours, including travelling time. Any extra materials or plant hire will be charged at cost.</p> <p>Unless agreed in writing this quotation assumes:</p> <ol style="list-style-type: none">1) Good Vehicle Access2) Flat Level Site3) Subject to Site Survey4) No Penalty Clauses5) No Retentions		

Code	Goods	Rate	VAT
1	6006.66	20.00	1201.33

TOTAL VALUE	6006.66
TOTAL VAT	1201.33
ORDER TOTAL	7207.99



Welcome to our Play Area!

- Please help us to look after our park
- Please keep dogs out
- Please pick up litter
- Please do not smoke
- Please respect our play area
- Please report any damage to:
The Lawn Trust, the Parish Council or
William Westley school.

Thank you,
the children of Whittlesford.





24-36 Lamson Road
Rainham
Essex

RM13 9YY
TEL : 01708 25 35 45
FAX : 01708 25 35 50

WEIGHT (KG) : 907.47
PAGE : 1
CUSTOMER CODE: L56130
QUOTE DATE : 30/07/2021
YOUR ORDER NO: Enq: Hilary Workman
QUOTE BY : David Hill
DECISION DATE: 29/09/2021
THIS IS NOT AN INVOICE

INV TO: Wickhambrook Parish Council
123 York Road
Bury St Edmunds
Suffolk
IP33 3EG

DEL TO: AS INVOICE-TO

Dear Sirs,

We thank you for your enquiry. We are delighted to offer the following prices for your consideration.

Product Code	Qty	Description	Price	Discount	Net
51RBTC1212BM	51.49	ROSPA Bowtop Concrete In Fence 1200mm x 12mm Bar-PPC Black - p/m	58.40		3007.02
51RBTS LC121212LB	1	Single Leaf Gate 12 x 1200mm L/H - Concrete-in - PPC Black	523.70		523.70

**** Thank you for your enquiry ****

Prices quoted will be valid for 5 days from date of quotation

Goods	Vat	Total
3530.72	706.14	4236.86

To place an order please give me a call or speak to our sales staff who are always willing to help and advise.

Kind regards,

David Hill
for F.H. Brundle

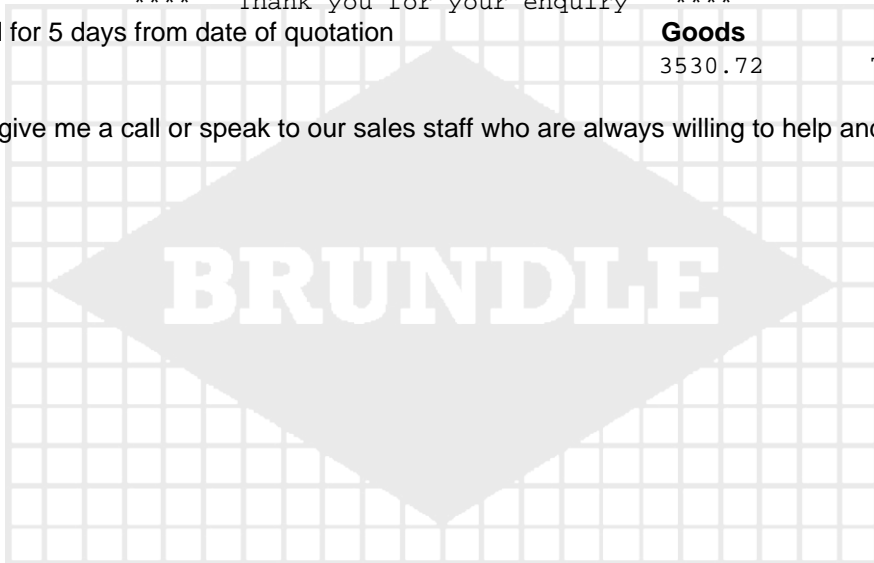

Please ask for a catalogue on our vast range of products or visit www.fhbrundle.co.uk
Director: **MICHAEL F. BRUNDLE**

. Welded Mesh . Expanded Metal . Perforated Steel . Wrought Iron Components . Industrial Fencing . Prorailing .
. Automated Gate Systems . Tuebclamps and Tube . Stairtreads and Handrail Standards . Steel Sections .

VAT Registration No.GB 232 2423 10



From: [John Hambrook](#)
To: [Hilary Workman](#)
Subject: Re: bow top fencing for play areas
Date: 30 July 2021 15:47:30

Good Afternoon Hilary,

Apologies I missed that it is the bow top fencing you are after. we supply this in 1m or 1.2m heights.

- supply & INstallation of 49 linear metres of 1m high painted steel bow top fencing including spung self closing gate - £6,065 + VAT (1.2m height option - £6,675+ VAT)
- Removal of existing MUGA unit - £2150.00 + VAT

I hope that this will be helpful.

Kind Regards

John



John Hambrook |

UK Support Centre: Octavia House, Westwood Way, Coventry, CV4 8JP



If you have received this e-mail in error, please advise us immediately and delete this e-mail and any attachments from your computer system. idverde UK Support Centre: Octavia House, Westwood Way, Coventry, CV4 8JP. idverde UK Limited, Registered in England and Wales 06539986. The presence of this footnote confirms that this e-mail has been automatically checked by idverde for the presence of computer viruses prior to being sent, however, no guarantee is given or implied that this e-mail is virus free upon delivery.

Save a tree. Please don't print this e-mail unless you really need to.

From: Hilary Workman <parishclerk@wickhambrook.org.uk>
Sent: 30 July 2021 12:48
To: John Hambrook <John.Hambrook@idverde.co.uk>
Subject: RE: bow top fencing for play areas

[EXTERNAL EMAIL] This email originated from outside of the organisation. Do not click links or open attachments unless you recognise the sender and know the content is safe.

Hi John, yes, could you quote for 1 m and 2m high. Could you quote with and without removal – the existing panels are wooden attached wooden posts,